

PLAN URBANISTIC ZONAL

ELABORARE SI APROBARE P.U.Z. -

ZONA DE SERVICII

MUN. SATU MARE, INTRAVILAN, NR. CAD. 156303, JUD. SATU MARE
REGLEMENTARI ECHIPARE EDILITARA

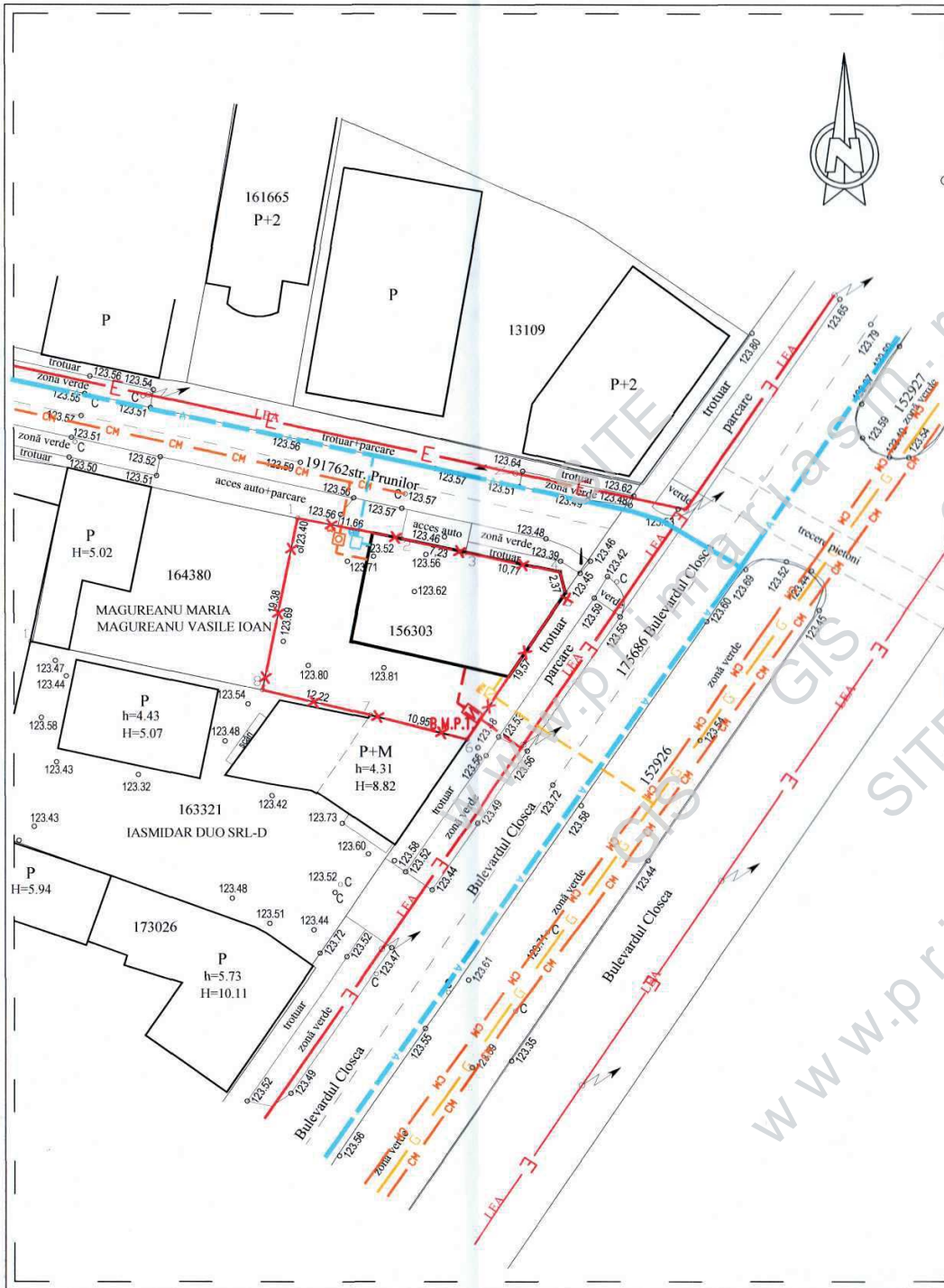

LEGENDA

LIMITE

--- LIMITA ZONEI STUDIATE

--- X --- LIMITA TEREN BENEFICIAR

--- ALINIAMENT PROPUIS

--- G --- REȚEA DE GAZ EXISTENTA
--- BRANSAMENT GAZ PROPUIS

--- A --- REȚEA DE APA RECE MENAJERA EXISTENT
--- BRANSAMENT APA RECE MENAJERA PROPUIS

--- CH --- REȚEA DE CANALIZARE MENAJERA EXISTENTA
--- BRANSAMENT DE CANALIZARE MENAJERA PROPUIS

--- E --- LINIE ELECTRICA AERIANA EXISTENTA
--- BRANSAMENT ELECTRIC SUBTERAN DE 0.4 KV PROPUIS

--- CONSTRUCTIE PROPUISA

--- B.M.P.T. BLOC MASURA SI PROTECTIE TRIFAZAT

--- Ca --- CAMIN APOMETRU

--- Cr --- CAMIN RACORD CANAL

--- PRM --- POST REGLARE MASURARE GAZE

DENUMREA REȚELEI	LUNGIME
REȚEA DE APA	12 m
REȚEA DE CANALIZARE	12 m
REȚEA DE GAZE NATURALE	24 m
LINIE ELECTRICA 0,4KV	12 m

ERYZA DESIGN S.R.L.

sat. Caraseu, nr. 405, jud. Satu Mare
Tel./Fax 0261.877.700

ELABORARE SI APROBARE P.U.Z.
ZONA DE SERVICII

MUN. SATU MARE, INTRAVILAN, NR. CAD. 156303, JUD. SATU MARE

PR.
20/2025

SEF PROIECT arh.BABICI NICOLAE
PROIECTAT ing.COMIATI OVIDIU
DESENAT arh.TAKACS ANDREA

SCARA
1:500

BENEFICIAR: BARSEUAN MARINEL-IOAN
SI BARSEUAN GEORGETA

REGLEMENTARI ECHIPARE EDILITARA

FAZA
P.U.Z.
Ed1